



WEBB SCHOENFELD
10/17/2024

4x4's or 2x4's with chamfer cut at top to fit in the frame beam. You'll have to cut to length based on your camper height. I'd measure from upper web of beam down to grade when level and kick it out at roughly the angle shown in picture. This angle shown is a good angle for maximized stability. But depending how un-level the site is, this angle varies. Every campground is different so sometimes they get more vertical and sometimes more kicked out, which effects stability. Even if they are more vertical, or angled out, stability is drastically improved.

You can also use x-chokes between the tires but this only helps stability lengthwise, not side to side from my experience. I don't use them anymore, as they don't really help with my larger camper, 43' 5er is what we have, shown in this picture.

Ratchet strap

Extra blocks to make up un-level camp grounds. I have probably 10-15 of these I keep, to use under the jacks, and / or under these stabilizers, along with 2x4's and some 1x's. These are 4x4's I cut a bunch of the same length that fit nice in my cubby hole in the storage compartment.

3/8" thick (round bar diameter) lag eye bolt

JT STRONG ARM (OR EQUIV) PERMANENT STABILIZING OPTION

JT STRONG ARM IF YOU WANT TO BUY A PERMANENT STABILIZING SYSTEM. MAKE SURE EVERYTHING IS SECURE (NUTS, HARDWARE, ETC) AS THIS CAN COME LOOSE AND BE LOST ON THE ROAD.



Lippert
JT's Strong Arm Jack Stabilizer Kit for 5th Wheel RVs w/ 58" or More Between Landing Gear
Part Number: LC191023
★★★★★ 119 Reviews | 100 Questions

In Stock
\$364.24
Retail: \$429.58
You Save: \$65.34

1

ADD TO CART

*** KEY TO HELP REMOVAL WHEN PACKING UP TO LEAVE ***

TO REMOVE WHEN PACKING UP TO LEAVE, UNDO RATCHET STRAP. THESE BOARDS WILL BE STUCK MOST OF THE TIME. IF YOU BEAT THEM OUT, THE WOOD SPLINTERS.

- TO REMOVE, DO THE FOLLOWING:
- RAISE CAMPER OEM STABILIZER JACKS OR REAR LANDING GEAR.
 - TONGUE / FRONT LANDING GEAR STILL DOWN.
 - RAISE THE TONGUE / FRONT LANDING GEAR JUST A HAIR AND REMOVE THE FRONT BOARDS.
 - THEN LOWER THE TONGUE / LANDING GEAR JUST A HAIR TO GET THE BACK ONES FREE.

LENGTH TO BE DETERMINED BY MEASURING FROM UPPER INSIDE OF BEAM DOWN TO GROUND AT APPROXIMATE ANGLE SHOWN.
WHEN CAMPING, BRING BLOCKS TO PUT UNDER STABILIZERS TO MAKE UP HEIGHT BASED ON CAMPSITE LEVELNESS.

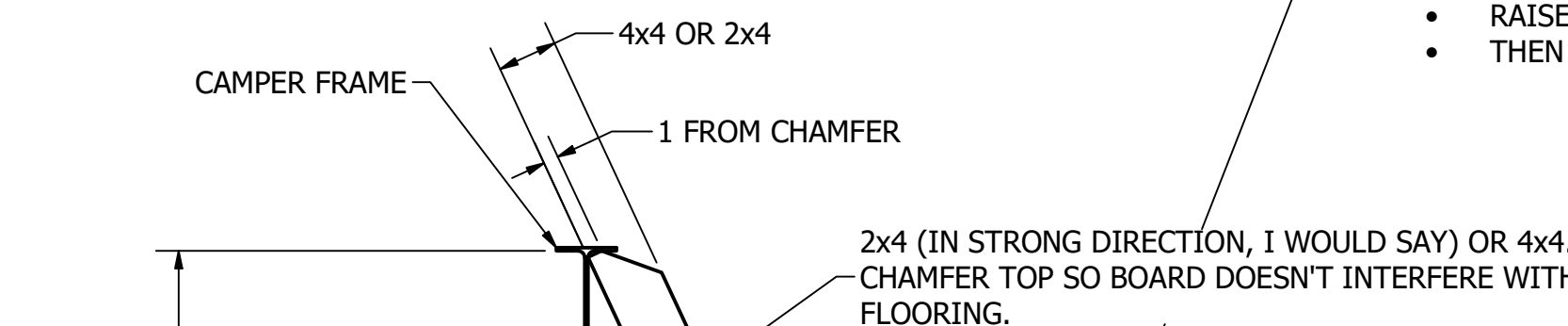
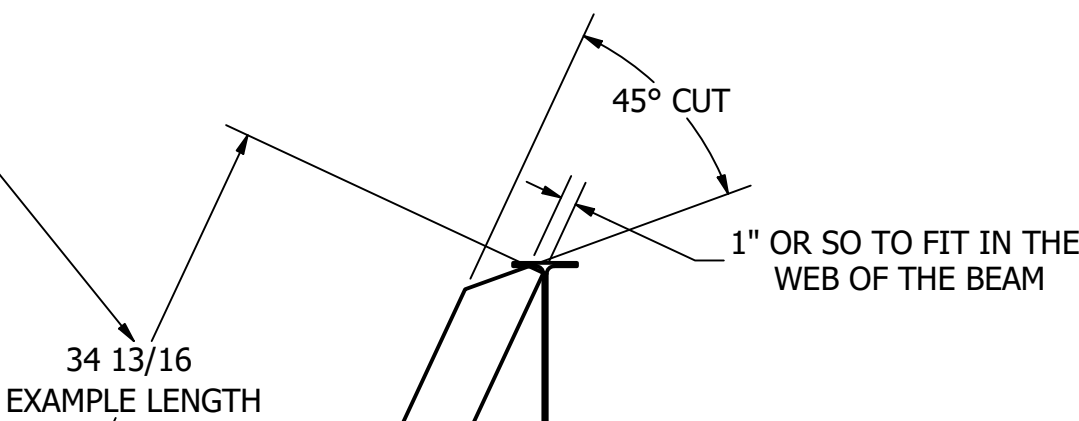

I'VE SEEN SOME PEOPLE CUT THESE FLAT (CUT AT A SPECIFIC ANGLE) FOR FULL CONTACT SURFACE. BUT THAT ONLY WORKS IF YOU HAVE THE SAME LEVEL GROUND AT EVERY CAMPSITE, OR IF YOU ARE PERMANENT.

IF YOU TRAVEL FROM PARK TO PARK, I WOULDN'T DO THIS. LEAVE THE CUT AT 90° OR ROUND THE BOTTOMS AS SHOWN ON OPP SIDE. THIS IS BECAUSE MOST CAMP SITES ARE AT DIFFERENT INCLINES, OR YOU MAY HAVE A STABILIZER ON THE GRASS INSTEAD OF ASPHALT / CONCRETE, DIFFERENT HEIGHTS, ETC.

THE ANGLE OF THE STABILIZERS VARY FROM PARK TO PARK.

RATCHET STRAP. TIGHTEN AS MUCH AS YOU CAN. I USE 2 HANDS ON THE FINAL CLICK AND CALL IT GOOD.

32 EXAMPLE HEIGHT. CHECK YOUR HEIGHT WHILE TRAILER IS LEVEL.

3/8" THICK (ROUND BAR DIA) LAG EYE BOLTS. 2.5" TO 3" DEEP INTO THE WOOD.

1/4" THICK EYE BOLTS AREN'T STRONG ENOUGH AND WILL OPEN / BEND THE EYE. LEARNED THE HARD WAY.

OPTIONALLY ROUND THE ENDS. I HAVEN'T DONE THIS BUT NOT A BAD IDEA. PROBABLY WILL ON NEXT SET.

DUCT TAPE AROUND WOOD TO HELP WOOD FROM SPLINTERING.

POSITION AS CLOSE TO FRONT OF CAMPER, AND AS CLOSE TO BACK OF CAMPER. REQUIRES (4). YOU COULD EVEN MAKE ANOTHER SET FOR THE MIDDLE OF THE CAMPER.

YOU MAY HAVE TO AVOID STORAGE CONTAINERS, OR PROPANE CONTAINER / BOX, OR PROPANE LINES, OR SLIDE MECHANISMS, DEPENDING ON YOUR SPECIFIC CAMPER.

FOR MY CAMPER, THE FRONT STABILIZERS CAN'T BE INLINE FROM ONE SIDE TO THE OTHER. SO I GET THEM POSITIONED, AVOIDING THE STORAGE COMPARTMENT AND PROPANE TANK BOX, THEN I RATCHET. THEY'RE NOT INLINE BUT STILL WORKS VERY WELL FOR STABILITY. PREVIOUS CAMPER DID NOT HAVE THIS ISSUE, SO DEPENDS ON YOUR CAMPER.

